

Small, smart and  
fully automatic

Schaerer Coffee Joy



 **schaerer**

Coffee comes to life



## Superior class in a compact design

**Superb quality at the press of a button, an elegant compact design and simple operation: Schaefer Coffee Joy is a delight for smaller applications that call for 30 to 50 cups a day.**



---

### The small professional

---

With a width of only 30.5 cm, Schaefer Coffee Joy is the smallest in our range of fully automatic coffee machines. It is ideal for applications such as bars, offices and meeting rooms. When it comes to coffee quality, beverage selection and operating comfort, it matches the capabilities of our larger high-performance coffee machines. Like these, it contains the latest Schaefer coffee machine technology and a fully automatic milk system.



---

### Six different beverages just a touch away

---

Whether your preference is espresso, café crème, cappuccino or latte macchiato: just a small tap on the touch panel and Schaefer Coffee Joy guarantees you great coffee enjoyment. In addition, hot milk, milk foam or hot water can be dispensed by a simple touch. Thanks to the “double function” buttons and the double outlet, Schaefer Coffee Joy can simultaneously prepare two beverages. The “barista” button gives you the freedom individually to set the coffee strength.



---

### Impeccably hygienic

---

With the Schaefer Coffee Joy you can always count on Schaefer’s hygiene standards. They fulfil all international regulations pertaining to milk processing and milk system cleaning. Nothing will detract from your enjoyment of the perfect cup of coffee.



# Schaerer Coffee Joy at a glance



## The advantages

- Superb coffee quality
- Six beverages at a touch
- Simple operation
- Easy and rapid cleaning
- Elegant, compact design
- Hourly/daily output of 30 – 50 cups (depending on beverage)



## Equipment

- User-guided liquid crystal display in 10 languages
- Barista button for individually setting the coffee strength
- Integrated milk foamer for creamy milk foam
- Height-adjustable double outlet
- Inlet for ground coffee (e.g. caffeine-free)
- Grinder with precision grinding discs
- Modern brewing technology
- Integrated water tank
- Cup counter
- Passively heated cup storage



## Cleaning

- Automatic cleaning and decalcification programme
- Fulfills HACCP-compliant hygienic regulations
- Simple removal of the brewing unit for cleaning
- "Easy Clean" milk cleaning system

## Options

- Bean hopper extension (total capacity 650 g)
- External cooling unit for milk

## Technical data

|   |                                 |
|---|---------------------------------|
| Dimensions (W/H/D):                       | 305 / 445 / 405 mm              |
| Dimensions bean hopper extension (W/H/D): | 305 / 505 / 445 mm              |
| Weight:                                   | Approximately 15 kg             |
| Nominal power:                            | 1.7 – 2.3 kW                    |
| Power supply:                             | 1/N/PE ~50/60 Hz<br>120 – 240 V |
| Height-adjustable outlet:                 | 70 – 135 mm                     |
| Water tank:                               | 2.2 l                           |
| Bean hopper (standard):                   | 250 g                           |
| Bean hopper extension:                    | 650 g capacity total            |

## Dimensions

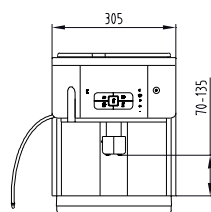

Schaerer Coffee Joy

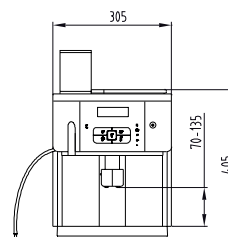
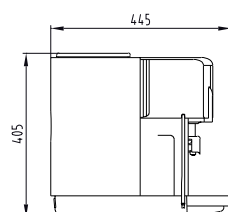

Schaerer Coffee Joy  
with bean hopper extension

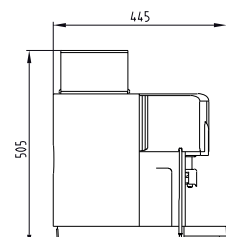

## Headquarters

### **Schaerer Ltd.**

Allmendweg 8  
4528 Zuchwil  
Switzerland  
info@schaerer.com

## Subsidiaries

### **Schaerer USA Corporation**

2900 Orange Avenue, Suite 102  
Signal Hill, CA 90755  
USA  
info@schaererusa.com

### **Schaerer Deutschland GmbH**

Siechenlach 1  
89173 Lonsee-Urspring  
Germany  
info@schaerer-gmbh.de  
www.schaerer-gmbh.de

### **Schaerer Benelux-Guy van Bogaert**

Boomsesteenweg 608  
2610 Wilrijk-Antwerpen  
Belgium  
info@schaerer.be

[www.schaerer.com](http://www.schaerer.com)